

PerformINS

WALL WRAP BREATHER

Product Information

PerformINS Wall Wrap Products are specifically manufactured to the highest industry standards.

PerformINS Wall Wrap

- ✓ Satisfy BCA specifications and requirements for Reflective Foil Laminates
- ✓ Complies with the specifications and requirements of AS/NZS 4200.1 for "Pliable Building Membranes" which is a manual recognised by the BCA Part 3.5 Roof and Cladding
- ✓ Low Flammability Index in accordance with AS 1530.2 <5
- ✓ Satisfy BCA Part 3.7.1 Fire Hazard Properties
- ✓ Satisfy Health & Safety Regulations

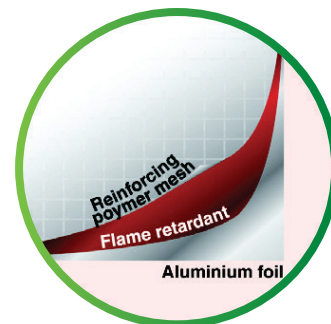

Wall Installation

Up to R1.1 may be added to the wall system when PerformINS Wall Wrap is installed as wall cladding behind brick veneer/timber cladding. Our specialised manufacturing process bonds together Aluminium Foil to a high strength reinforcing Polymer Mesh using a flame retardant adhesive. Our Reinforcing Polymer Mesh is purposely-treated blue in colour to reduce reflective glare problems when PerformINS Wall Wrap is installed.

PerformINS Wall Wrap Usage

In all applications:

- External cladding should be installed A.S.A.P
- No contact is to be made with wet concrete or mortar
- Store in dry area, weather proofed only after installation
- Shrinkage of up to 2% can be expected

In reflective foil laminate applications:

- Use only in accordance with AS/NZS 4200.2 for the "Installation Requirements for Pliable Building Membranes"
- Minimum of 20mm air space is recommended adjacent to reflective foil face to achieve Maximum insulation values

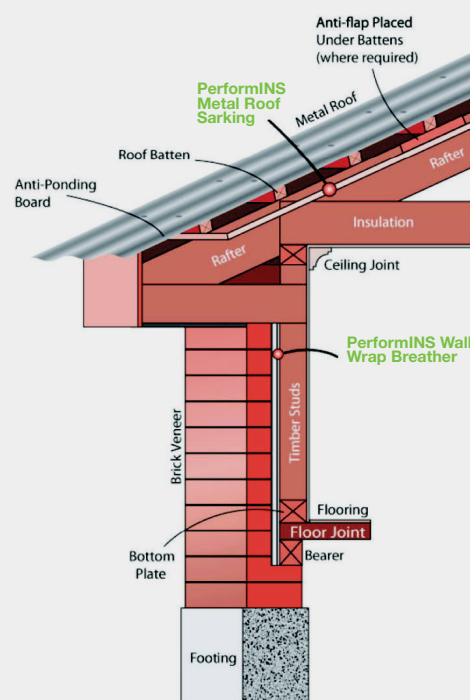

Recommended Applications and Properties

	Breather		Breather
Residential Wall Insulation	✓	Tensile Strength Machine Direction (kN/M)	min 12.5
Commercial Wall Insulation	✓	Tensile Strength Lateral Direction (kN/M)	min 7.5
Duty	Heavy	Edge Tear Resistance Machine Direction (N)	min 80
Vapour Barrier	High	Edge Tear Resistance Lateral Direction (N)	min 80
Emittance	Reflective	Water Vapour Transmission Rate (Ng/Ns)	min 140
Water Barrier	Unclassified	Emittance of Reflective Face	max 0.05
Flammability Index < 5	< 5		

Availability			Breather
Width 1350mm	Length 30m	Area 40.5m ²	✓
Width 1500mm	Length 30m	Area 45m ²	✓