

SISALATION™ 437/440

Medium Duty Foil Laminate

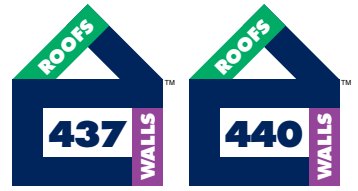

PRODUCT DESCRIPTION

Insulation Solutions™ *Sisalation 437/440* are manufactured from two outer layers of aluminium foil and two layers of high density kraft paper. These layers are bonded together using flame retardant adhesive and reinforced with glass fibres arranged in a 25mm x 14mm grid. One aluminium face of *Sisalation 437* is coated white. One aluminium face of *Sisalation 440* is blue to reduce any problems with reflected glare during installation.

Sisalation 437 is recommended for use in conjunction with FBS-1 Bio Soluble Glass Wool™ Insulation as a decorative facing and as a vapour barrier for roof and wall insulation.

Sisalation 437 may be perforated for use in conjunction with FBS-1 *Glass Wool* where acoustic performance criteria is required.

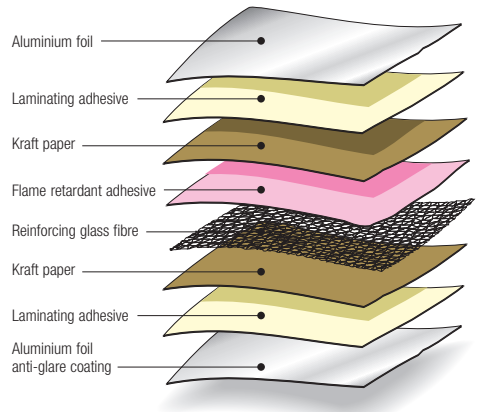

FBS-1 *Glass Wool* building blanket with *Sisalation 437* adhered is available from *Insulation Solutions* as *Permastop™ 437*.

PRODUCT APPLICATION

Sisalation 437 is designed primarily for use as sarking and insulation under metal roofs and in walls in sports stadiums, manufacturing and warehousing facilities and generally in areas where a decorative finish is required. It is also suitable for livestock and agricultural buildings, where hygiene is maintained by regular cleaning with water and detergents. When installed as an exposed internal roof lining, the white reflective properties will enhance lighting.

Sisalation 437 can be coated in a variety of colours.

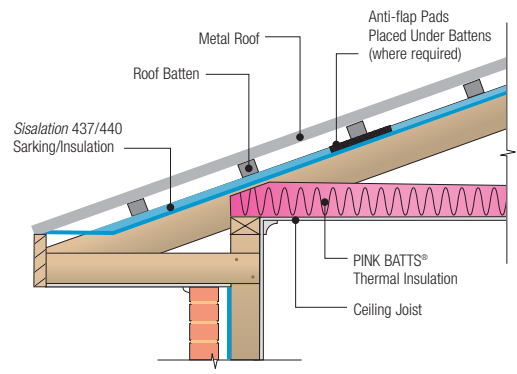

PRODUCT FUNCTION

INSULATION

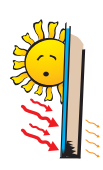

When installed under a metal deck roof as an exposed roof lining, *Sisalation 437* or *440* will provide additional thermal insulation (R0.7 to R1.8) to the roof system, depending on method of installation and direction of heat flow.

ENERGY EFFICIENCY



As insulation, *Sisalation 437/440* will reduce summer heat gain and winter heat loss in a building. Importantly this will enhance energy efficiency and help reduce greenhouse gas emissions. *Sisalation 437/440* have good/high (respectively) light reflectivity. When installed in buildings as exposed internal roof linings, the reflectivity of the ceilings is increased by up to 40%. This reduces artificial lighting loads and further enhances energy efficiency.

VAPOUR BARRIER



Sisalation 437/440 will provide an effective vapour barrier when overlapped and sealed with *Insulation Solutions Vapastop™ 883* self adhesive aluminium foil tape.

FIRE PERFORMANCE



Sisalation 437/440 is flame retardant and is suitable for use in buildings in bushfire prone areas to help lessen fire hazard by preventing the ingress of sparks into the roof space.

SISALATION™ 437/440

Medium Duty Foil Laminate

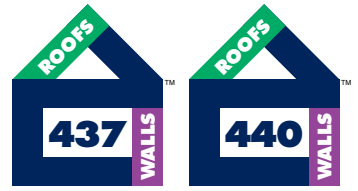

SPECIFICATION

Sisalation 437/440 satisfies the BCA requirements for sarking type materials. It complies with the requirements of AS/NZS4200.1, for “Pliable Building Membranes”, which is a deemed-to-satisfy manual

recognised by the BCA Part 3.5 Roof and Wall Cladding. It has a low flammability index in accordance with AS1530.2 which satisfies the BCA Part 3.7.1 Fire Hazard Properties.

INSTALLATION

When used as a sarking, all installation should be in accordance with AS/NZS4200.2 “Installation requirements for Pliable Building Membranes.” To provide optimum insulation values, a minimum air

space of 20mm is required adjacent to the reflective foil face. In high wind areas, it may be necessary to install anti-flap pads.

PHYSICAL PROPERTIES

Sisalation 437/440 exhibit the following properties as defined by AS/NZS4200.1 for “Pliable Building Membranes”.

CLASSIFICATIONS:

Duty	Medium
Vapour Barrier	High
Emittance	Reflective
Water Barrier	High
Flammability Index	Low

Tensile Strength Machine Direction kN/m	Min 9.5
Tensile Strength Lateral Direction kN/m	Min 6.0
Edge Tear Resistance Machine Direction N	Min 65
Edge Tear Resistance Lateral Direction N	Min 65
Water Vapour Transmission Rate ng/Ns	Max 2
Emittance of Reflective Face	Max 0.05

CHEMICAL PROPERTIES

DURABILITY

When installing *Sisalation 437/440* the cladding should be installed without delay.

RESISTANCE TO ALKALIS

Aluminium foil is susceptible to alkali attack, so *Sisalation 437/440* should not be used in contact with wet concrete or mortar.

HEALTH & SAFETY

There are no known health or safety risks associated with this product for applications described in this data sheet. For additional information, or a Material Safety Data Sheet, please contact your nearest *Insulation Solutions* office.

STANDARD ROLL SIZES

Roll Width	1350mm	1350mm
Roll Length	60m	20m
Roll Area	81m ²	27m ²

WARRANTY

Sisalation 437/440 is warrantied against UV exposure for 3 years.

SUSTAINABILITY

Sustainability...measures that satisfy the needs of people today while enhancing the quality of life for future generations. The demands on non-renewable resources for the production of energy are not sustainable without compromising the environment. Insulation,

correctly specified and installed, is one of the most beneficial products in improving energy efficiency and reducing greenhouse gas emissions.

