

INTERNAL WALL AND UPPER FLOOR ACOUSTIC INSULATION SYSTEMS THAT SAVE YOUR SANITY

Why install acoustic insulation in walls between “quiet” rooms (like living areas) and “noisy” rooms (like bathrooms or kids rooms)? Because the difference it makes to your privacy and comfort can be dramatic.

The *Glass Wool* acoustic batts used in *QuietZone* systems (*Noise Control Batts* and *SonoBatts*) are part of the EcoPink® Insulation System, which also includes PINK BATT® insulation for energy savings and Sisalation™ reflective foil laminate for weatherproofing.

These acoustic insulation batts will assist in separating noisy areas from rooms where you want peace and quiet. The diagrams on this page show you the effect *QuietZone* systems can have in reducing the amount of noise that gets through typical stud walls.

So, how quiet do you like it? Take a look inside this brochure and choose the *QuietZone* acoustic insulation system that best suits your needs.

Rw is a term used to measure airborne sound transmission loss through a building element, such as a wall, floor, pipe. The Rw ratings shown can be achieved using typical building materials - 75mm timber studs, 10mm SoundStop™ plasterboard and acoustic insulation batts installed between the studs.

The higher the Rw rating, the less noise you'll hear from upstairs or the next room.

TYPICAL NUISANCE NOISES	SOUND LEVEL DECIBELS (dB)
Vacuum cleaner	84-89
Hairdryer	80-95
Small Radio/TV	75-85
Raised Voices	70-80
Handheld Computer Games	68-76
Telephone	66-75

Normal conversation is 55-65dB.

Comfortable Background Noise Level 35-45dB

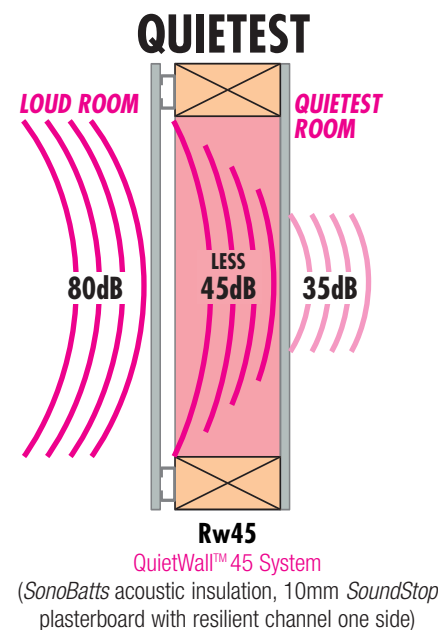
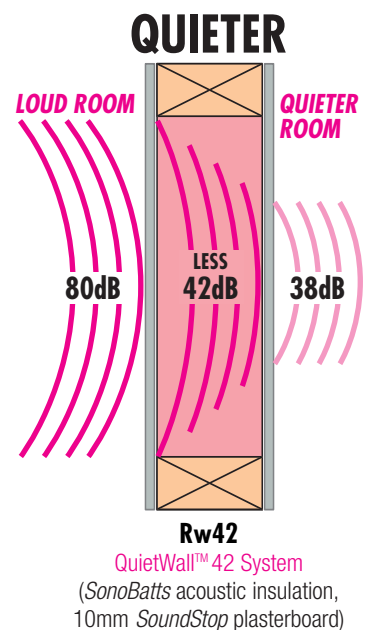
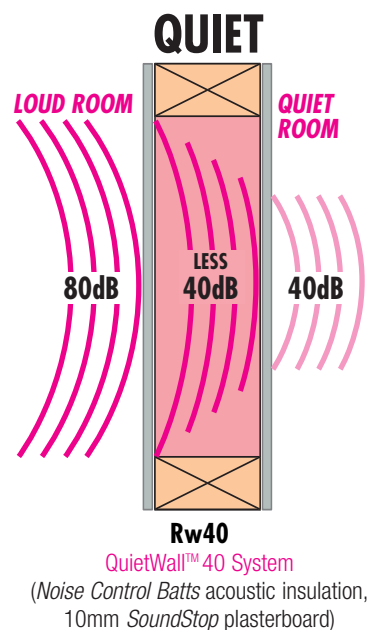
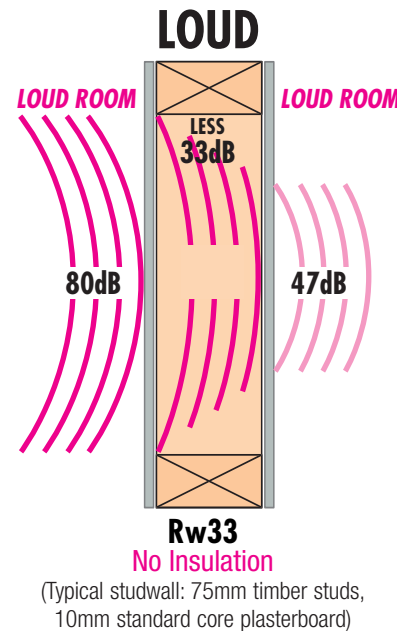

QUIET AND COMFORTABLE

Before you build, choose the level of *ECOPINK QuietZone* noise control insulation to suit your requirements. There's a *QuietZone* system that's easy to install in standard timber or metal framed construction to give you quiet, quieter or the very quietest zones in your new home or extension. *QuietZone* products even have the added benefit of providing efficient thermal insulation, so you can save money on energy bills by only heating or cooling the areas of your home you need to.

For the sake of your sanity, it's time to choose *QuietZone* noise control insulation. To find out more...

1800 626 624

or for further technical details on product, refer to the appropriate data sheets, available at:

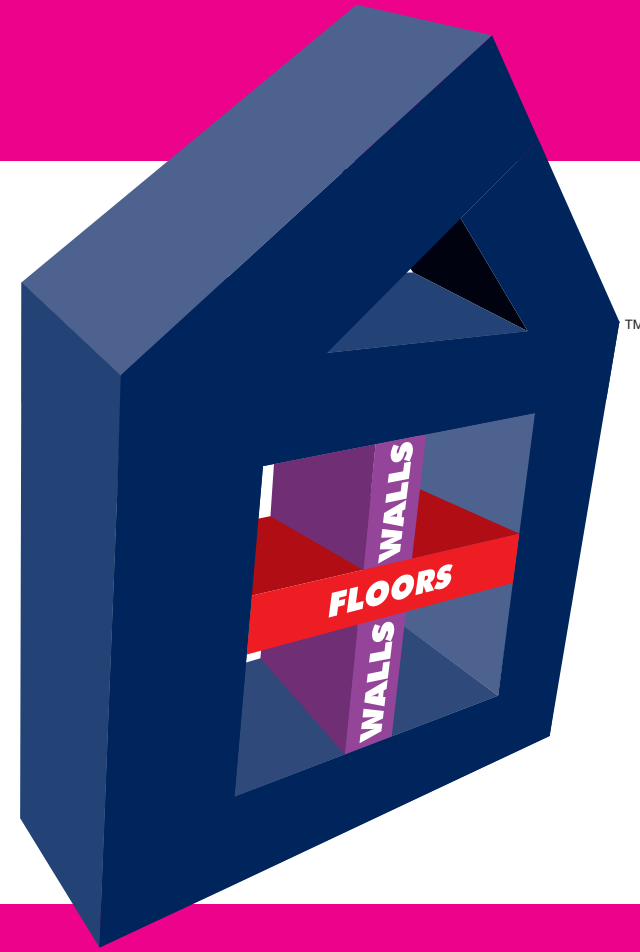

PINK® ACOUSTIC INSULATION FOR INTERNAL WALLS AND UPPER FLOORS



URNS HOMES INTO QUIET ZONES™

Available from:

FRECALL 1800 626 624

WEBSITE: www.eurekainsulation.com.au



The contents of this brochure are copyright protected and may not be reproduced without the written consent of Insulation Solutions Pty. Ltd. Recommendations and advice regarding the use of the products described in this brochure are to be taken as a guide only, and are given without liability on the part of the company or its employees. We reserve the right to change product specifications without prior notification. The purchaser should independently determine the suitability of the product for the intended use and application.

Insulation Solutions Pty. Ltd. ABN 15 083 169 402, *PINK is a registered trademark used under licence by Insulation Solutions Pty. Ltd., ™SoundStop is a trademark of Boral Plasterboard. ™Trademarks of Insulation Solutions Pty. Ltd. *ECOPINK is an initiative of Insulation Solutions Pty. Ltd. ©Copyright 2004. ISR12187MDG-6/04



QUIET...

QUIETER...

QUIETEST...



INTERNAL FRAMED WALLS

QuietWall™40 - voices can just be heard but not understood

75mm timber framing with stud spacings of 450mm. System consists of 10mm SoundStop® plasterboard to both wall surfaces with 75mm Noise Control Batts™ fitted between the studs.

QuietWall40 provides effective low level noise control between rooms such as bedrooms but is not recommended in situations where loud noise such as music could cause a problem to an adjoining quiet area.

UPPER FLOORS

QuietFloor™39 - voices can just be heard but not understood and walking can be heard as a low frequency thump

Timber floor and timber floor joists, (450mm spacings) with 10mm SoundStop plasterboard ceiling and 100mm Noise Control Batts fitted between joists.

QuietFloor39 provides effective low level noise control from upstairs. The addition of carpet to the floor is beneficial in reducing impact noise, such as foot steps.

INTERNAL FRAMED WALLS

QuietWalls™42 – very loud voices can just be heard but not understood

75mm timber framing with stud spacings of 450mm. System consists of 10mm SoundStop plasterboard to both wall surfaces with 75mm SonoBatts™ fitted between the studs.

QuietWall42 provides effective moderate level noise control between rooms such as family entertainment areas and lounge rooms.

UPPER FLOORS

QuietFloors™40 – loud voices very hard to hear and heavy walking can be heard as a low frequency thump

Timber floor and timber floor joists, (450mm spacings) with 10mm SoundStop plasterboard ceiling and 100mm SonoBatts fitted between joists.

QuietFloor40 provides effective moderate level noise control from upstairs. The addition of carpet to the floor is beneficial in reducing impact noise, such as foot steps.

INTERNAL FRAMED WALLS

QuietWall™45 – loud speech can be heard as a murmur.

75mm timber framing with stud spacings of 450mm. System consists of 10mm SoundStop plasterboard fixed to both surfaces with furring channel to one side with 75mm SonoBatts fitted between the studs.

QuietWall45 provides effective higher level noise control between rooms such as home entertainment rooms and bedrooms or nurseries.

UPPER FLOORS

QuietFloor™46 – loud voices can just be heard but not understood and walking can be heard as a very low frequency thump.

Timber floor and timber floor joists, (450mm spacings) with 10mm SoundStop plasterboard ceiling fixed to joists with furring channel and 100mm SonoBatts fitted between joists.

QuietFloor46 provides effective higher level noise control from upstairs. The addition of carpet to the floor is beneficial in reducing impact noise, such as foot steps.

PLUMBING

QuietPipe™ - efficient noise control insulation for waste and water pipes.

The perfect noise control insulation for plumbing installed in framed walls and upper floors of bathrooms, ensuites, kitchens and laundries, QuietPipe deadens the noise generated by running water and can be used in conjunction with any of the QuietZone noise control systems.

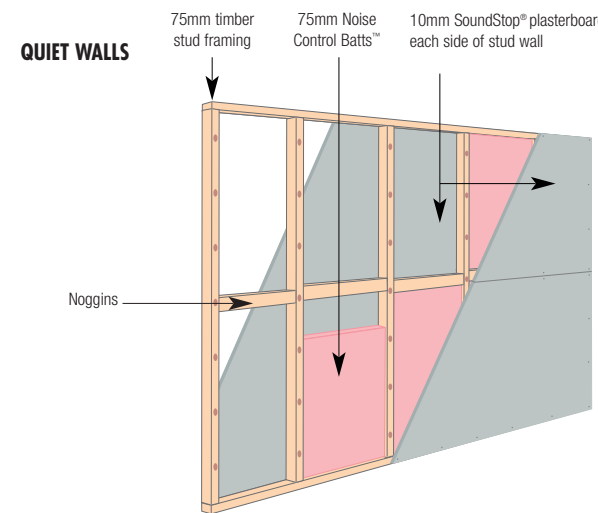

Note: 90mm studs will increase the acoustic control performance of the wall system

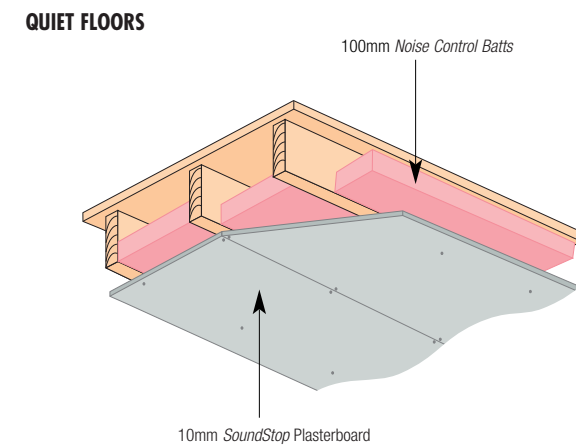

Note: System based on standard timber floor joists.

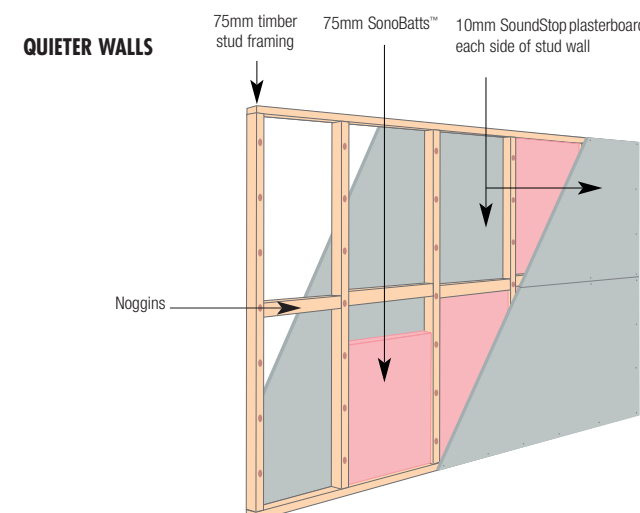

Note: 90mm studs will increase the acoustic control performance of the wall system

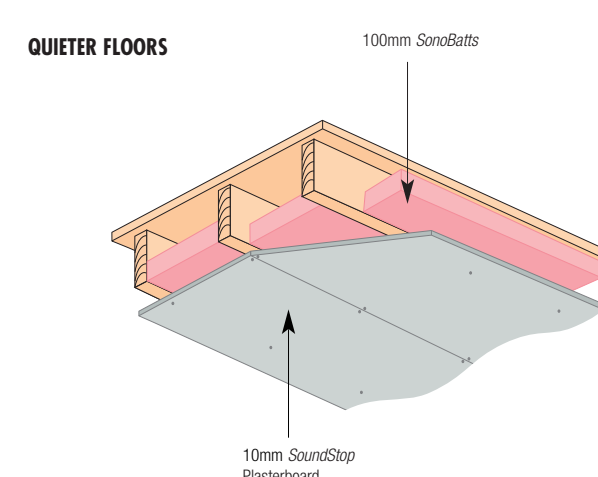

Note: System based on standard timber floor joists.

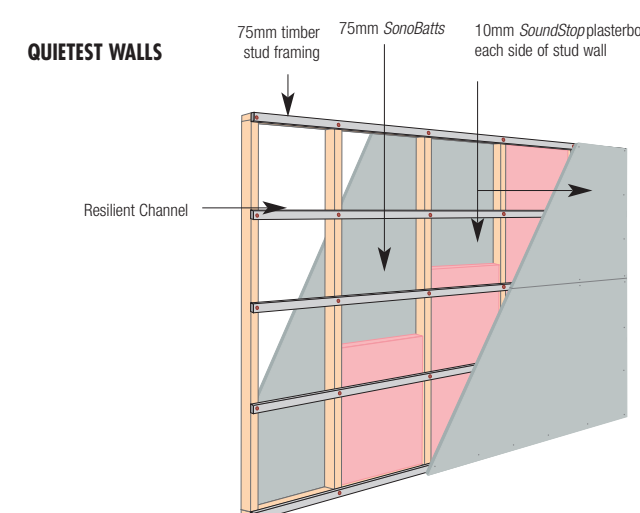

Note: 90mm studs will increase the acoustic control performance of the wall system

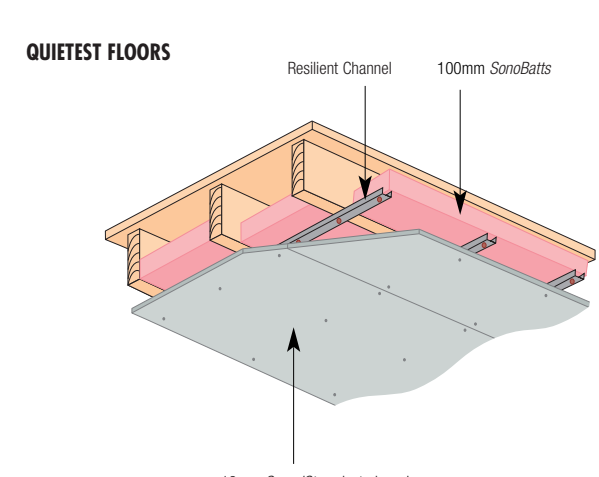

Note: System based on standard timber floor joists.